

# Simple Touch® 15-Channel Remote Cellular Shade

## - Installation and Care Instruction

### Installation

**Identify your cellular shade and parts** (your parts may vary, depending on the custom request, size of the headrail & shade you are purchasing.)

Shade width	Qty of brackets
W ≤ 36"	2
36" < W ≤ 72"	3
72" < W ≤ 96"	4
96" < W ≤ 120"	5

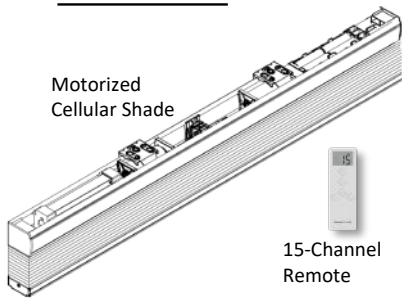

9/16" rail brackets    3/4" rail brackets



screws

Rechargeable battery pack    The cord length is 20".

Mounting brackets



Screws

USB wall charger

15-Channel Remote

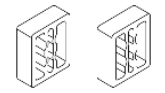

Spacers (optional)



Extension brackets (optional)

Rechargeable battery pack (\*The default quantity of the charger and USB cord is 1 set per order. You can request more sets at no cost up to the same quantity as the rechargeable battery pack you ordered.)

### Tools you may need (not included)

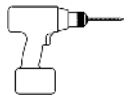

Drill with bits



Metal tape measure



Pen



#4 x 3/4" flat head wood screw



Screwdriver

### FOR 3/4" HEADRAIL BRACKETS

#### Install the brackets

- Mark the bracket locations, separating the brackets evenly. Make sure all brackets are aligned and level with each other.
- For inside mount - Install the bracket with the hole at top center by using the included screw or with two holes at the top rear side by using #4 x 3/4" flat head wood screws (not included).
- For outside mount – install the bracket with two holes at the back side with included screws.

- Fasten the screws completely.
- Install the shade with the extension brackets (optional)
  - Install the extension bracket with at least 2 screws.
  - Attach the mounting brackets to the extension brackets with the screws.

Use #4 x 3/4" flat head wood screws (not included) for these two holes

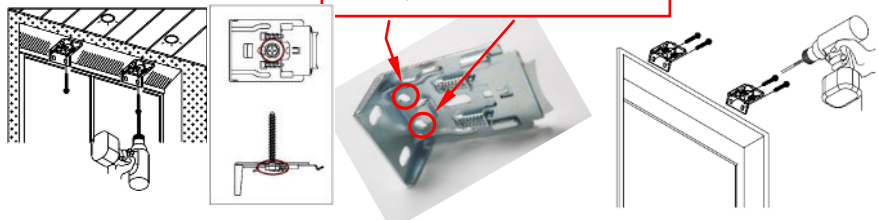

Inside Mount

Outside Mount

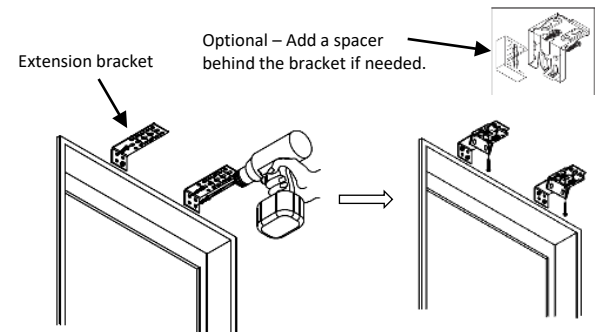

#### Install the rechargeable battery pack

- Follow the user guide for the Simple Touch rechargeable battery pack.
- The rechargeable battery pack can either be hooked onto the back side of the headrail or mounted to the wall or window frame.

#### Attach the cell shade to brackets

- Position the headrail with the front lip resting on the top hooks of all the brackets.
- Push the bottom of headrail firmly upward and toward the window until the groove at the bottom of the headrail snaps into place.

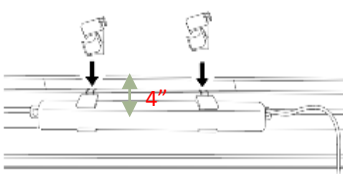

or

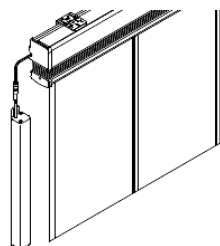

The minimum flush mounting space is 4" while using 3/4" headrail.

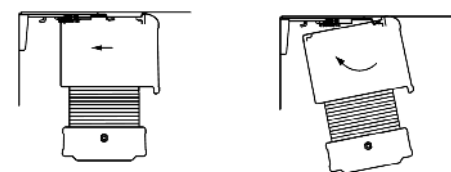

### How to remove the shade from the brackets

- Raise the shade completely. Push the headrail toward to the wall.
- Tilt the backside of the headrail down
- Once the back of the headrail clears the brackets, pull the headrail off the front of brackets.

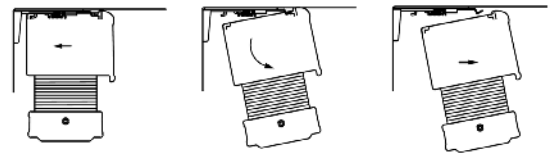

### FOR 9/16" HEADRAIL BRACKETS

#### Install the brackets

- Mark the bracket locations. Space the brackets evenly and make sure the brackets will not interfere with any mechanism or other internal headrail parts.
- Install the brackets using screws (included) and tighten them completely.
- Make sure all brackets are aligned and level with each other.

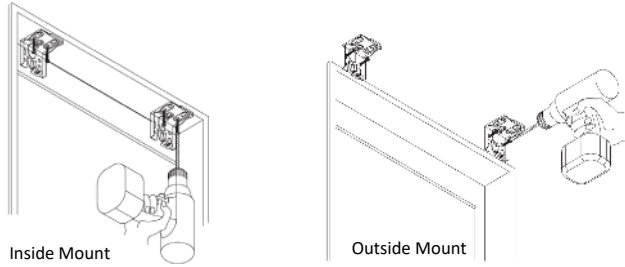

- Install the shade with extension brackets (optional)
  - Install the extension bracket with at least 2 screws.
  - Attach the hidden brackets to the extension brackets with the screws.

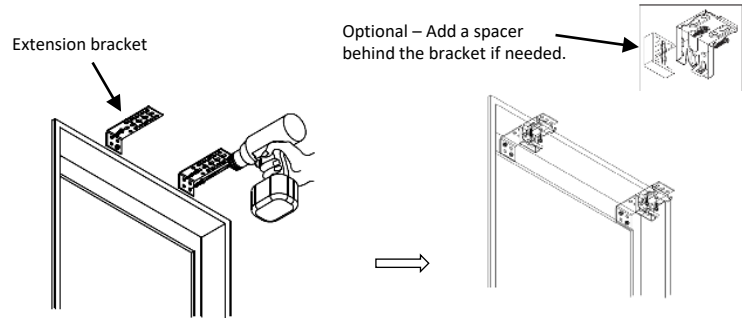

#### Install the rechargeable battery pack

- Follow the user guide for the Simple Touch rechargeable battery pack.
- The rechargeable battery pack can either be hooked onto the back side of the headrail or mounted to the wall or window frame.

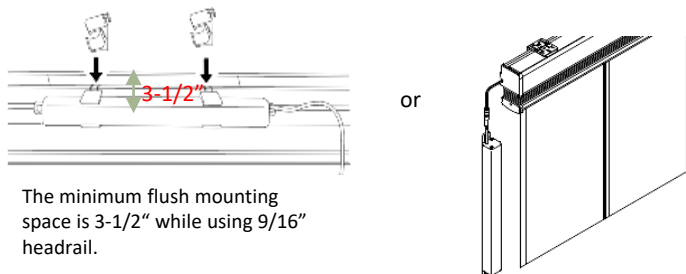

The minimum flush mounting space is 3-1/2" while using 9/16" headrail.

#### Attach the cell shade

- Position the headrail with the front lip resting on the top hooks of all the brackets.
- Push the bottom of headrail firmly upward and toward the window until the groove at the bottom of the headrail snaps into place.

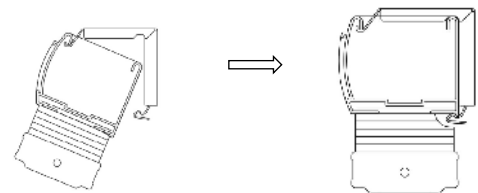

### How to remove the shade from the brackets

- Use the remote to raise the shade completely.
- Use a flat screw to push the bracket tab toward to the wall. Once you hear a "click", then the shade will be released from the bracket.
- Repeat above step to release the shade from other brackets.

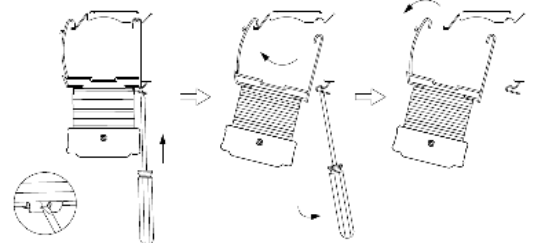

## Care and Clean

- Wipe the shade periodically with a soft dust cloth or dusting mitt, or vacuum with a lowest speed.

#### Notes

- Do not spill water to the headrail and the remote.
- Do not clean/ operate the motorized shade with wet hands
- The warranty for your shades does not cover damage caused by improper cleaning.
- Changing the batteries or charging the rechargeable battery pack won't change the programming setting.
- The motorized shade is for indoor use only.
- Do not use the motorized shades at the wet area.

**FCC**

ID# 2AWSE-STP054

FOR INDOOR USE ONLY

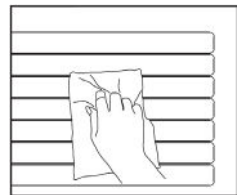

This motorized shade has been tested and found to complete with the limits for a Class B digital device, pursuant to part 15 of the FCC rules. These limits are designed to provide reasonable protection against harmful interference in a residential installation. This shade generates, uses and can radiate radio-frequency energy. If this shade is not installed and used in accordance with the instructions, it may cause harmful interference to radio communications. However, there is no guarantee that interference will not occur in a particular installation. If this shade does cause harmful interference to radio or television reception, which can be determined by turning the shade off and on, correct the interference by one or more of the following measures:

Reorient or relocate the receiving antenna.

Increase separation between shade and receiver.

Connect equipment to an outlet on a circuit different from that to which the receiver is located.

Consult your dealer or an experienced radio/TV technician.

Any changes or modifications to the product that are not expressly approved by HT could void the user's authority to operate this shade. Use of a shielded interface cable is required to comply with the Class B limits of Part 15 of FCC rules. For more regulatory information, see the electronic user guide. HT shall not be liable for any direct, indirect, incidental, consequential, or other damage alleged in connection with the furnishing or use of this information.

**No programming needed. We have programmed your shade.  
The programming steps below are optional.**

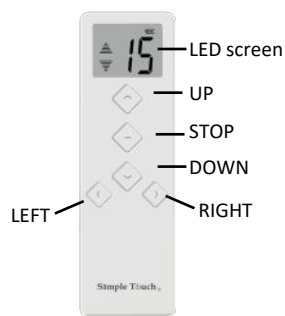
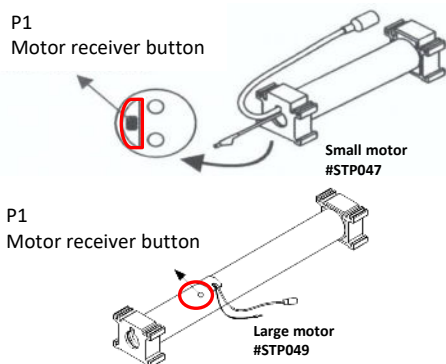

Front side of the remote

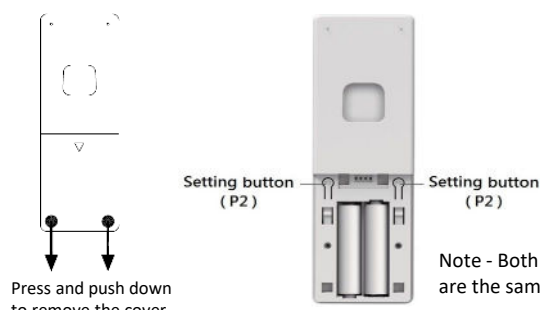

Back side of the remote

Note - Both P2 buttons are the same.

- The default group control is on channel #0.
- Option to set up “MY FAVORITE POSITION” if you prefer, simply follow the instructions below. Once you have set it up, you will be able to quickly access your preferred position with just the press of the STOP button.
- Recharge the rechargeable battery pack doesn’t affect the setting of the shades.

## Optional Programming Instructions

### PROGRAMMING FOR MY FAVORITE POSITION

#### Set Up My Favorite Position

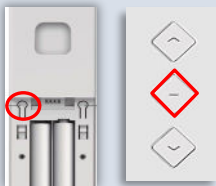

Step 1. Click the **LEFT** or **Right** buttons to select the channel you wish to program.

Step 2. Raise the shade all the way up by clicking the **UP** button. Skip this step if the shade is already at the top position.

Step 3. Adjust the bottom rail to your favorite height by clicking the **DOWN** or **UP** buttons and then hit the **STOP** button.

Step 4. Click either one of the **P2** buttons. The shade jogs once.

JOG x 1

Step 5. Click the **STOP** button once. The shade jogs once.

JOG x 1

Step 6. Click the **STOP** button again. The shade jogs twice.

JOG x 2

**My favorite position set up is done.**

#### Remove My Favorite Position

Step 1. Click either one of the **P2** buttons. The shade jogs once.

JOG x 1

Step 2. Click the **STOP** button once. The shade jogs once.

JOG x 1

Step 3. Click the **STOP** button again. The shade jogs once.

JOG x 1

**Remove My Favorite Position is done.**

### ADJUST THE TOP LIMIT

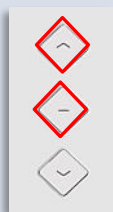

Step 1. Click the **LEFT** or **Right** buttons to select the channel you wish to program.

Step 2. Press the **STOP** and **UP** buttons for about 5 seconds until the shade jogs once.

JOG x 1

Step 3. Use the remote to control the shade to the desired upper position and then hit the **STOP** button.

Step 4. Press the **STOP** and **UP** buttons for about 2-3 seconds until the shade jogs twice.

JOG x 2

**Adjust the top limit is done.**

## ADJUST THE BOTTOM LIMIT to fit your window height



Step 1. Click the **LEFT** or **Right** buttons to select the channel you wish to program.

Step 2. Press the **STOP** and **DOWN** buttons for about 5 seconds until the shade jogs once.

JOG x 1

Step 3. Use the remote to control the bottom rail to fit your window height and then hit the **STOP** button.

Step 4. Press the **STOP** and **DOWN** buttons for about 2-3 seconds until the shade jogs twice.

JOG x 2

**Adjust the bottom limit** is done.

Note. Use the single-channel remote to adjust limits if you have a Simply stock motorized shade with a single-channel remote.

## ADD/ REMOVE A DUPLICATED REMOTE CONTROL

### ADD



Step 1. Select the channel you wish to copy by clicking the **LEFT** or **RIGHT** buttons.

Step 2. Click one of the **P2** buttons once on the existing remote. The shade jogs once.

JOG x 1

Step 3. Click the same **P2** button again. The shade jog once.

JOG x 1

Step 4. Select the channel you wish to copy on the **NEW** remote by clicking the **LEFT** or **RIGHT** buttons.

Step 5. Click one of the **P2** buttons on the new remote. The shade jogs twice.

JOG x 2

### REMOVE



Step 1. Select the channel on the remote you wish to keep by clicking the **LEFT** or **RIGHT** buttons.

Step 2. Click one of the **P2** buttons on the remote you wish to keep once. The shade jogs once.

JOG x 1

Step 3. Click the same **P2** button again. The shade jog once.

JOG x 1

Step 4. Select the channel on the remote you wish to delete by clicking the **LEFT** or **RIGHT** buttons.

Step 5. Click one of the **P2** buttons on remote you wish to delete. The shade jogs twice.

JOG x 2

## LOCK/ UNLOCK 3 FRONT BUTTONS to prevent resetting the top and bottom limits

### LOCK



Step 1. Press and hold the **STOP** button until “L” shown on the screen (about 15-20 seconds).

Step 2. Click **P2** button once, then the “half 0” symbol will be shown on the screen. **The lock setup** is done.

### UNLOCK



Step 1. Press and hold the **STOP** button until “U” shown on the screen (about 15-20 seconds).

Step 2. Click **P2** button once, then the “small square” symbol will be shown on the screen. **The unlock setup** is done.

## ADJUST THE MOTOR SPEED (Three speeds are available. When you don't get two jogs in the latest programming step, that means the motor is either at the highest or the lowest speed.)

### ACCELERATE



Step 1. Click one of the **P2** buttons once. The shade jogs once.

JOG x 1

Step 2. Click the **UP** button. The shade jogs once.

JOG x 1

Step 3. Click the **UP** button again. The shade jogs twice.

JOG x 2

### DECELERATE



Step 1. Click one of the **P2** buttons once. The shade jogs once.

JOG x 1

Step 2. Click the **DOWN** button. The shade jogs once.

JOG x 1

Step 3. Click the **DOWN** button again. The shade jogs twice.

JOG x 2

## REVERSE THE MOTOR DIRECTION

P1 motor receiver button

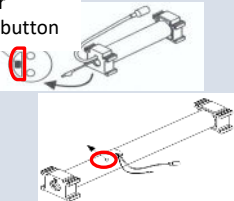

Step 1. Press the **P1** button on the shade you wish to program until the shade jogs 3 times (about 10 seconds). The location of the P1 button can be found on page 3.

JOG x 3

NOTE. The **P1** button is at side of the small motor and on the top of the larger motor. Refer to page 3 for the P1 location.

## SELECT THE TOTAL NUMBER OF CHANNELS YOU WISH TO SHOW ON THE SCREEN (Hide the unpaired channels)

### SELECT THE CHANNEL



Step 1. Press both the **LEFT** and **RIGHT** buttons at the same time (a “C” will appear on the screen), do not release them until a “15” appears on the screen (about 3 seconds).

Step 2. Select how many channels you wish to see on the screen by clicking the **LEFT** or **RIGHT** button.

Step 3. Click the “**STOP**” button. A “small square” will appear on the screen, followed by the channel number you selected.

The rest of the channels are hidden and cannot be accessed now.

### TO SHOW ALL 15 CHANNELS

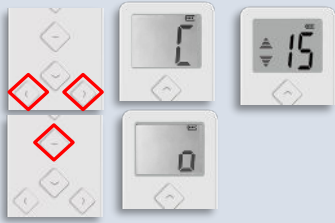

Step 1. Press both **LEFT** and **RIGHT** buttons at the same time (a “C” will appear on the screen), do not release them until a “15” appears on the screen (about 3 seconds).

Step 2. Select “15” by clicking the **LEFT** or **RIGHT** button.

Step 3. Click the “**STOP**” button. A “small square” will appear on the screen, followed by the number “15”.

Now all 15 channels are available.

**Warning:** In the rare instance that you may have to do a “**FACTORY RESET**”, follow the sequence and steps below. Complete to program “**PAIR THE REMOTE TO THE SHADE**”, “**SET UP THE TOP LIMIT**”, and “**SET UP THE BOTTOM LIMIT**” before operating the motorized shade again.

## FACTORY RESET

P1 motor receiver button

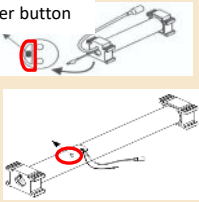

Step 1. Press the **P1** button on the shade you wish to reset until the shade jogs 4 times (about 15 seconds).

JOG x 4

**Note.** DO NOT RELEASE the P1 button during this step. If accidentally release it, please must redo it again. Different numbers of jogs will result in different settings.

## PAIR THE REMOTE TO THE SHADE

P1 motor receiver button

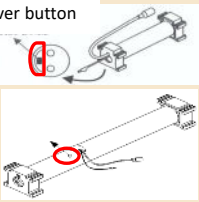

Step 1. Press the **P1** button on the same shade about 2-3 seconds. The shade jogs once.

JOG x 1

Step 2. Select the channel on the remote.

Step 3. Press the **STOP** button on the remote for about 2-3 seconds. The shade jogs twice. Make sure you stay at the same channel.

JOG x 2

## SET UP THE TOP LIMIT

TOP Limit



Step 1. Move the shade to the top position by pressing the **UP** button, then hit the **STOP** button when it reaches the top.

Step 2. Press both **UP** and **STOP** buttons for about 2-3 seconds. The shade jogs twice.

JOG x 2

## SET UP THE BOTTOM LIMIT

Bottom Limit



Step 1. Move the bottom rail to the bottom position by pressing the **DOWN** button, then hit the **STOP** button when it reaches the bottom.

**NOTE:** The setup will not succeed when the **STOP** button is pressed after the bottom rail passes through the bottom and then travels up. If it accidentally happened, start it again by pressing the **UP** button to raise the shade and repeat **Step 1**.

Step 2. Press both **DOWN** and **STOP** buttons for about 2-3 seconds. The shade jogs twice.

JOG x 2